

**NOTE:**  
THERE ARE NO HYDRANTS WITHIN 25m OF THE PADMOUNT SUBSTATION TRANSFORMER.

CLOSEST COMMUNICATIONS PIT (TELSTRA / NBN) 25m PLUS FROM PADMOUNT SUBSTATION TRANSFORMER.

PROPOSED 4800 x 5000 PADMOUNT SUBSTATION TRANSFORMER LOCATION.

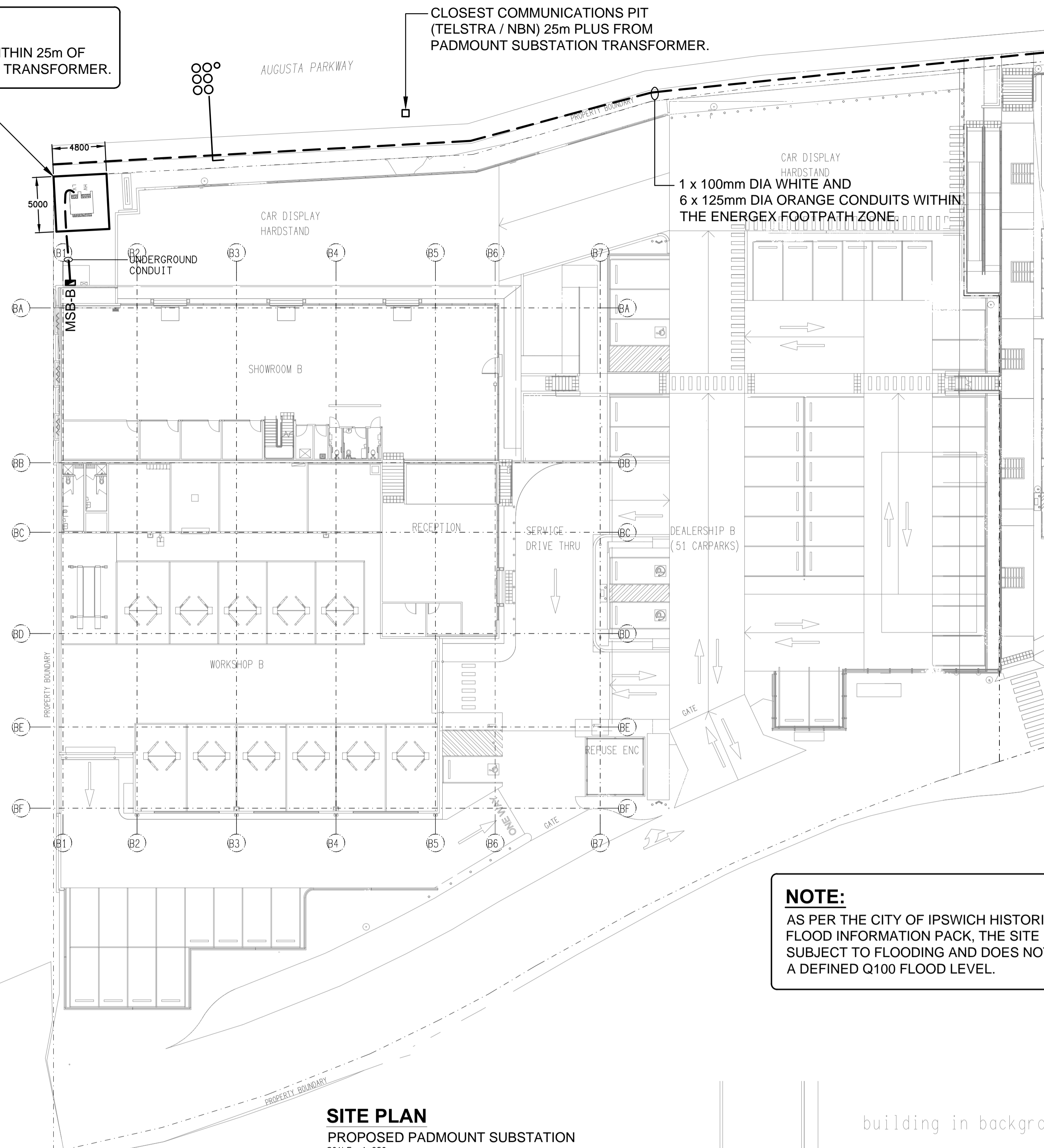

**SITE PLAN**  
PROPOSED PADMOUNT SUBSTATION  
SCALE 1:250

**NOTE:**  
AS PER THE CITY OF IPSWICH HISTORICAL FLOOD INFORMATION PACK, THE SITE IS NOT SUBJECT TO FLOODING AND DOES NOT HAVE A DEFINED Q100 FLOOD LEVEL.

**NOTE:**  
DO NOT RUN PRIVATE SERVICE CABLE THROUGH CULVERT

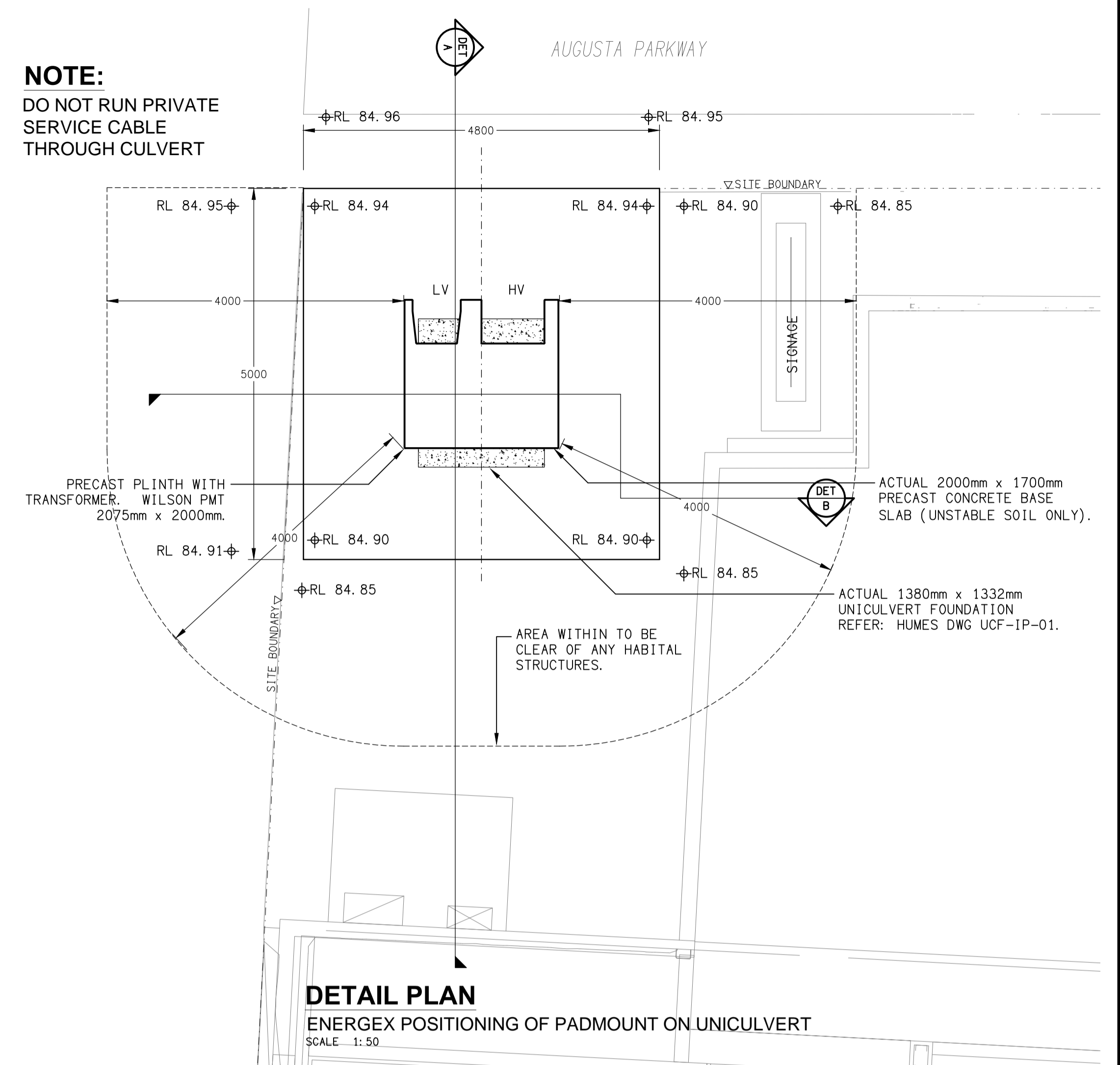

**DETAIL PLAN**  
ENERGEX POSITIONING OF PADMOUNT ON UNICULVERT  
SCALE 1:50

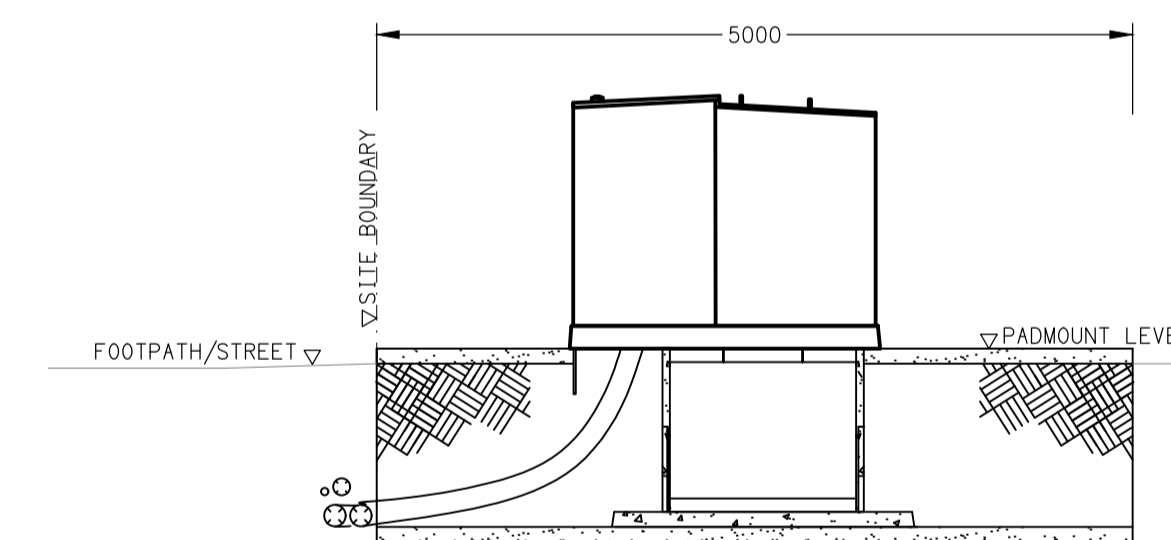

**DETAIL A**  
PADMOUNT SECTION VIEW  
SCALE 1:50

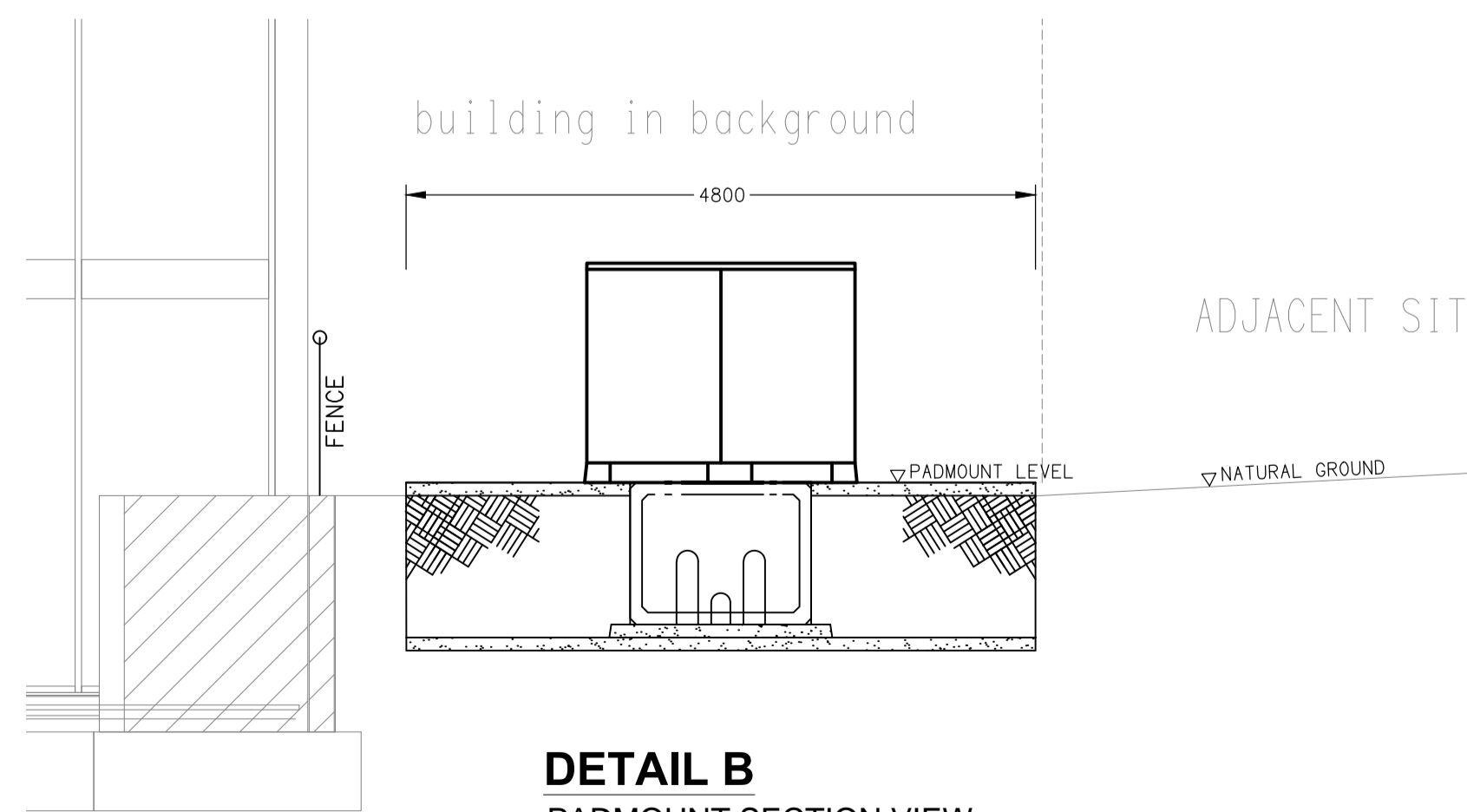

**DETAIL B**  
PADMOUNT SECTION VIEW  
SCALE 1:50



CULVERT INSPECTION REQUIRED BEFORE TRANSFORMER IS DELIVERED - 5 BUSINESS DAYS PRIOR NOTICE NEEDED.  
CONTACT: PAUL HAWKINS PH: 0419 756 501 EMAIL: ProjectCoordinationsesth@energex.com.au

TRANSFORMER WILL NOT BE ENERGISED UNTIL ALL REQUIREMENTS ARE MET.

ELECTRICAL DESIGN GROUP BRISBANE PTY LTD  
ACN 092 710 793  
TRADING AS:  
ELECTRICAL DESIGN GROUP

THE COPYRIGHT OF THIS DRAWING REMAINS THE PROPERTY OF THE ELECTRICAL DESIGN GROUP.  
USE FIGURED DIMENSIONS IN PREFERENCE TO SCALE.  
ALL DIMENSIONS TO BE VERIFIED ONSITE.



Rohrig (Qld) Pty Ltd  
ABN 67 093 753 970  
QBSA LIC NO 740842  
250 Abbotsford Road, Bowen Hills Qld 4006  
PO Box 86 Albion DC Qld 4010  
T+61 (7) 3257 4411 F+61 (7) 3257 2211  
www.rohrig.com.au

FOR ALL ENERGEX RELATED CONSTRUCTION QUERIES THE ELECTRICAL DESIGN GROUP ON (07) 3278 4375 IS THE FIRST POINT OF CALL.

**ELECTRICAL DESIGN GROUP**  
ELECTRICAL BUILDING SERVICES CONSULTANTS  
BRISBANE GOLD COAST  
P.O. Box 15, Sherwood Q.4075  
Phone: (07) 3278 4375  
Email: brisbane@edg.net.au  
Web: www.edg.net.au

PROJECT:  
**LLEWELLYN MOTORS SPRINGFIELD - LOT 32**  
LOT 32 AUGUSTA PARKWAY, AUGUSTINE HEIGHTS

|  |                              |                            |
|--|------------------------------|----------------------------|
| E  | ENERGEX APPROVAL             | 04/02/2025                 |
| REV:   | DESCRIPTION:                 | DATE:                      |
| DRAWING:<br><b>ELECTRICAL SERVICES</b><br><b>ENERGEX PADMOUNT SUBSTATION</b><br><b>SITE PLAN &amp; DETAILS</b> |                              |                            |
| SCALE:<br>1:250 & 1:50   | PROJECT NO:<br><b>C3294a</b> | DRAWING NO:<br><b>EN01</b> |
| AT A1  | REVISION:<br><b>E</b>        |                            |